

BORDO VIADOTTO senza mancorrente, $h = 100$

4
C.1.1

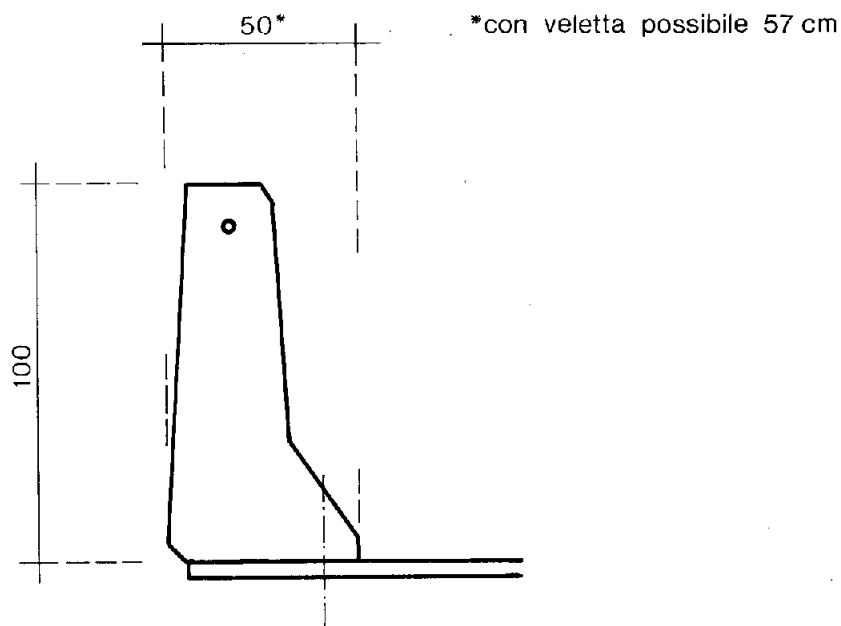

IMPIEGO

Bordo viadotti

CLASSE DI SEVERITA'

C Energia max. contenuta: 460 kN · m (con mancorrente)

MATERIALI

CALCESTRUZZO

RcK = 450 daN/cm²

COLLEGAMENTI

Barra diwidag Ø 20. Piastra acciaio Fe B32K

ARMATURA

Acciaio zincato Fe44K

ANCORAGGI

Con tasselli ad espansione in acciaio zincato classe 8.8

CONSIGLIATA PER:

Bordi viadotti di nuova e vecchia costruzione

Strade extraurbane con sensibile presenza di traffico medio e pesante.

Zona di approccio e centrali tra due viadotti affiancati a distanza ≤ 3 metri.

CERTIFICAZIONE

Basata sul complesso di prove eseguite sulla pista di Anagni nel periodo gennaio 1987-aprile 1988 e depositata globalmente presso il Ministero LL.PP. - Ispettorato Circolazione e Traffico.

C.1.1⁴

1.1

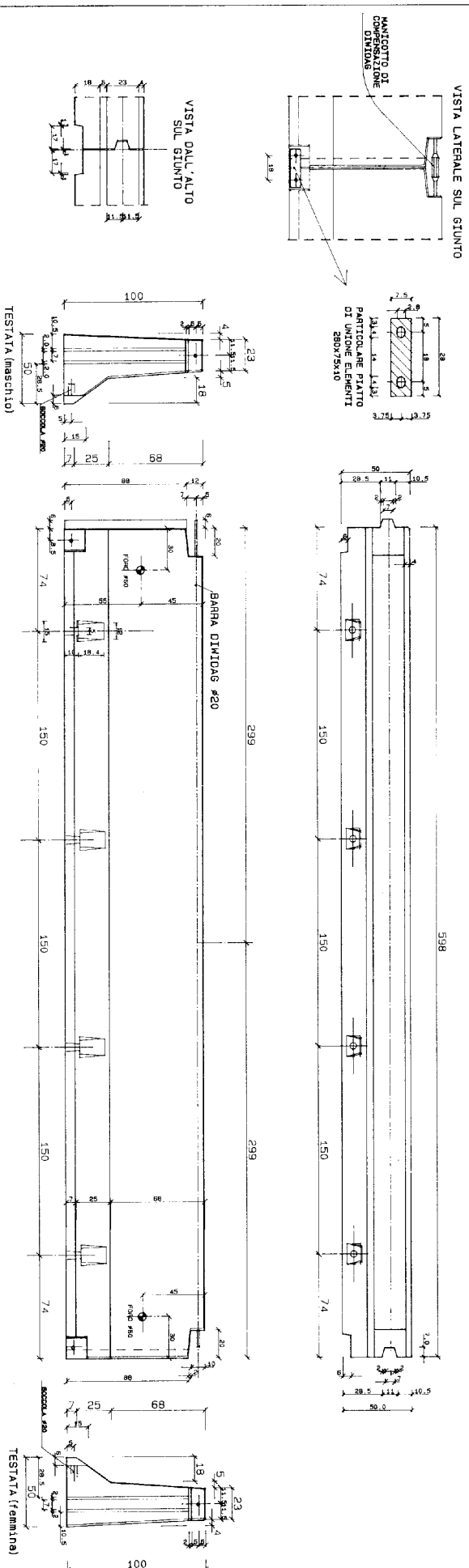
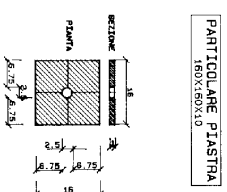
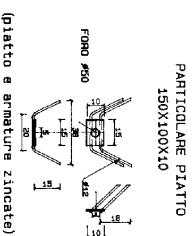
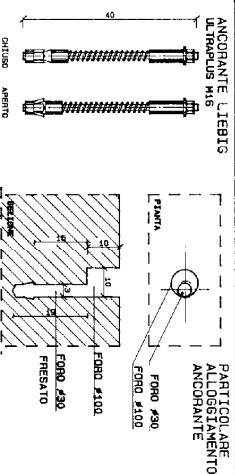
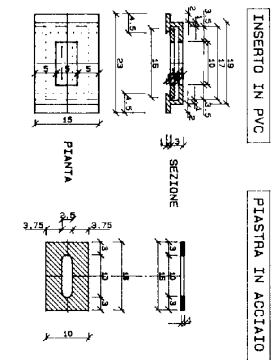
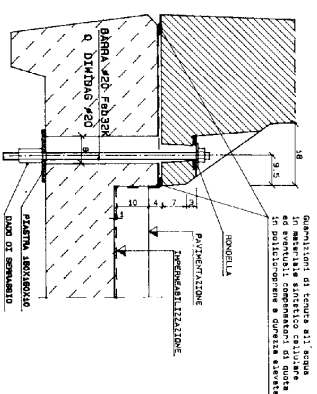
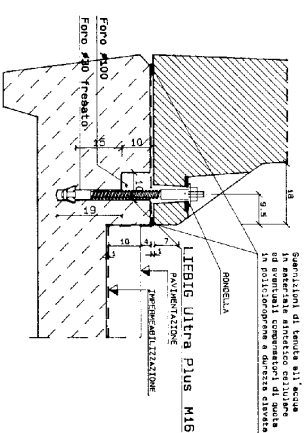
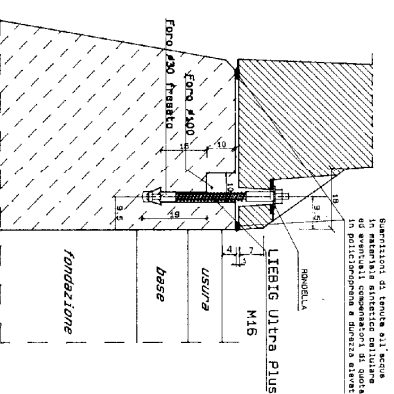
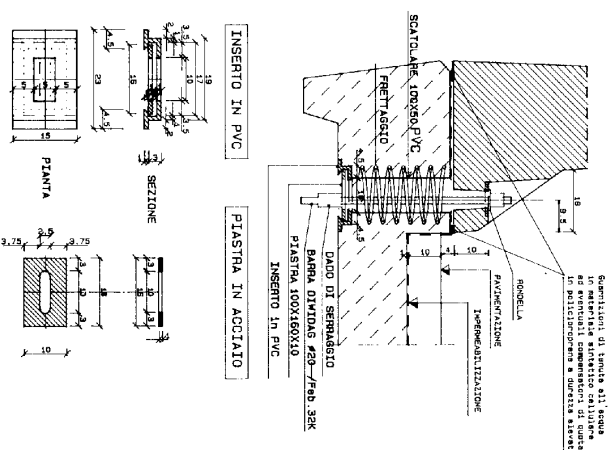
FISSAGGIO SU VIADOTTI
DI VECCHIA COSTRUZIONE

C.1.1⁴

ARMATURA

POS. 1 #20 DIWIDAG

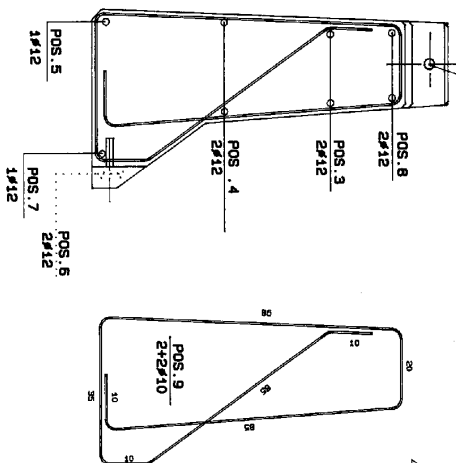

POS. 1 20 DIWIDAG

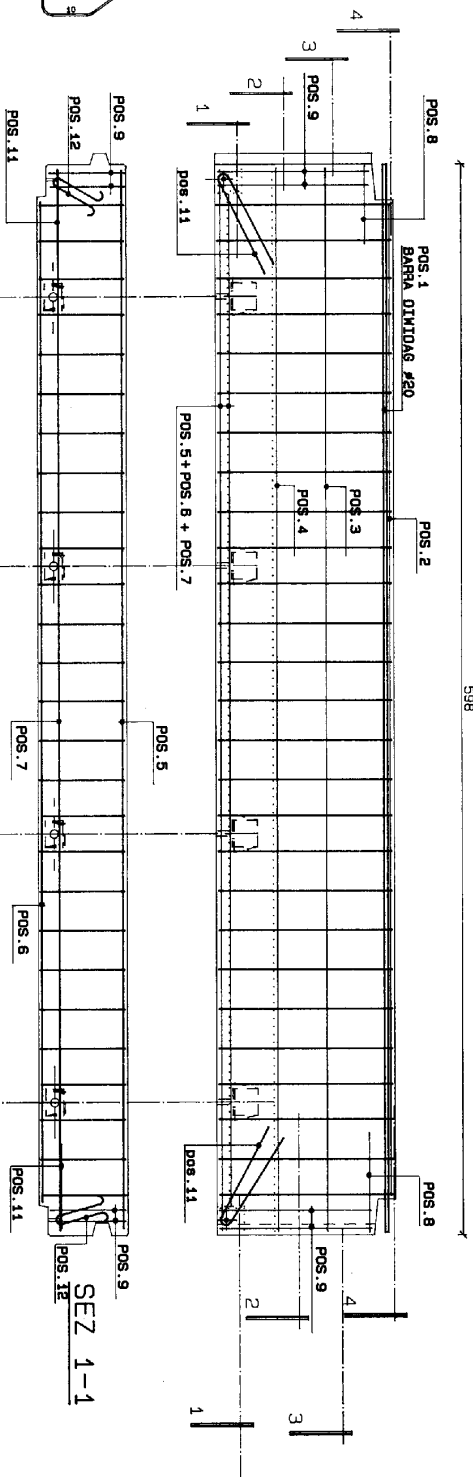
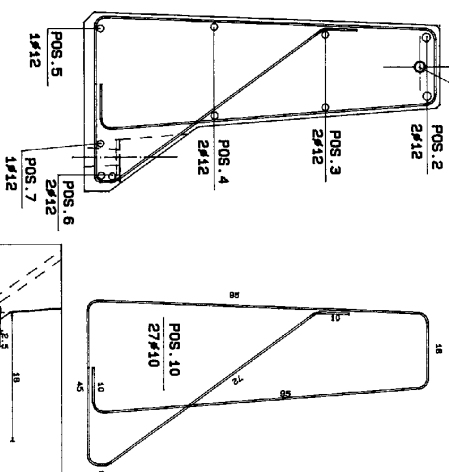

598

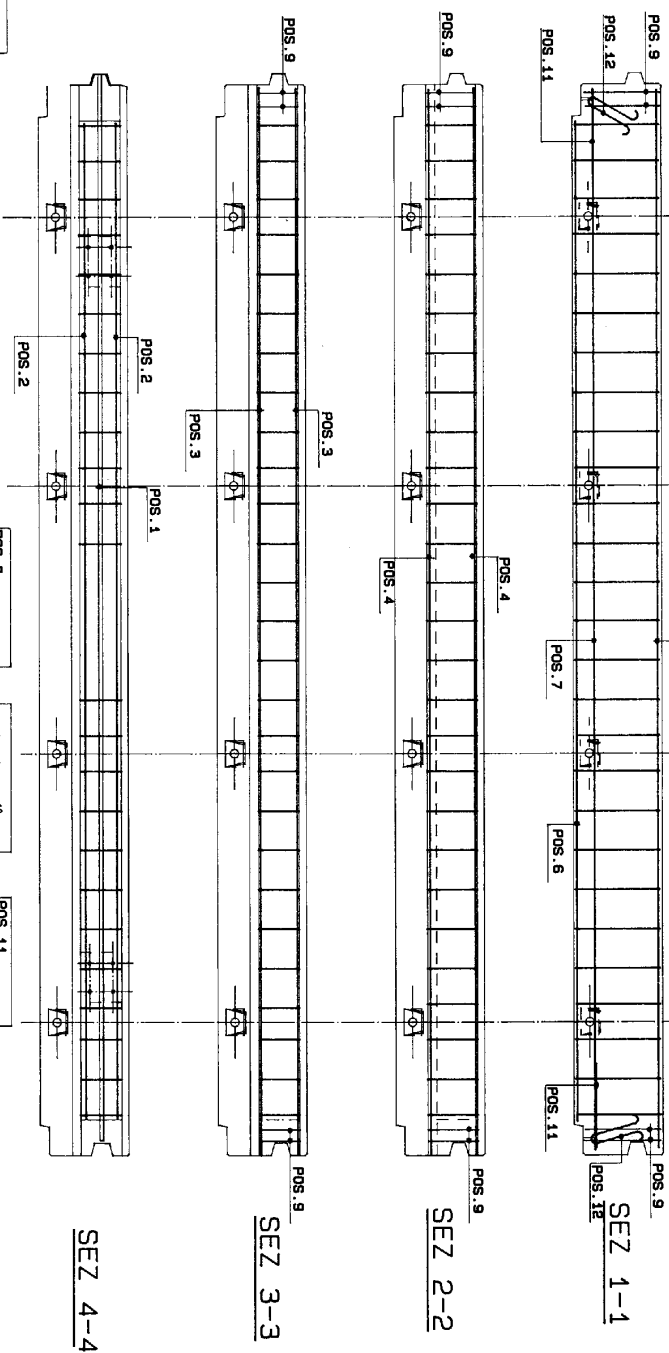

SEZ 4-4

SEZ 3-3

SEZ 2-2

SEZ 1-1
42

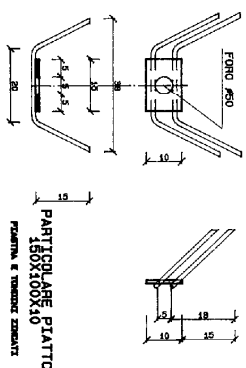
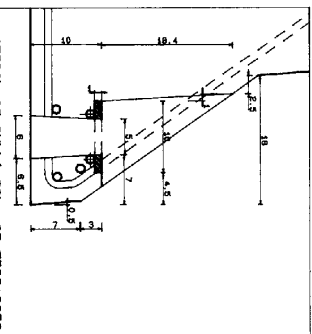
[illegible]

z. w.

OBBLIGATORIO L'USO DI DISTANZIATORI IN PLASTICA PER COPPIERO MINIMO 20mm.